

PAYNE AVENUE REHABILITATION PHASE 2 FROM EAST 30TH STREET TO EAST 55TH STREET

City of Cleveland
Pre Construction Meeting July 8, 2025
5:30pm

MAYOR'S OFFICE OF CAPITAL PROJECTS



CITY OF CLEVELAND
Mayor Justin M. Bibb

Meeting Agenda

1. Introduction

- Stephanie Howse-Jones
Council Member, Ward 4

2. Opening Remarks

- James DeRosa
Director of Capital Projects
- Richard J. Switalski, PE
Administrative Manager/
City of Cleveland

3. Project Review

- Christy George, PE
City of Cleveland Project Manager
- Chris Bednar, PE
Karpinski Engineering

4. Questions and Comments



Project Review

Contractor

- Terrace Construction

Construction Costs

- \$7,870,976.42
- Awarded to Terrace Construction
- OEO Goal Cleveland Small Business (CSB) = 30%

Project Funding Sources

- Ohio Public Works Commission (Issue 1 Funds)
- Road and Bridge Bonds and Utility Funds



Project Review

Construction Team

- City of Cleveland
 - Ron Mason, PE
Construction Section Chief – 216-857-1498
 - Christy George, PE
Project Manger– 216-664-2971
 - Cecil Benson
Inspector – 216—857-7648
- Contractor – Terrace Construction
 - Rick Mazzocco, Water Superintendent
 - Dave Mariola, Concrete Superintendent
 - Dan O’Day, Project Manager
 - Emergency After Hours – 216-861-8663



Project Review

- New Water Main with new connections and hydrants
- New asphalt pavement with full and partial depth repairs as needed
- Revise the travel lanes from 2 lanes in each direction to 1 lane in each direction with turn lanes at signalized intersections
- New bike lanes and/or sharrows will extend the length of the project are currently being developed
- Decorative crosswalks will be replicated along the corridor
- Intersection improvement at E 55th St

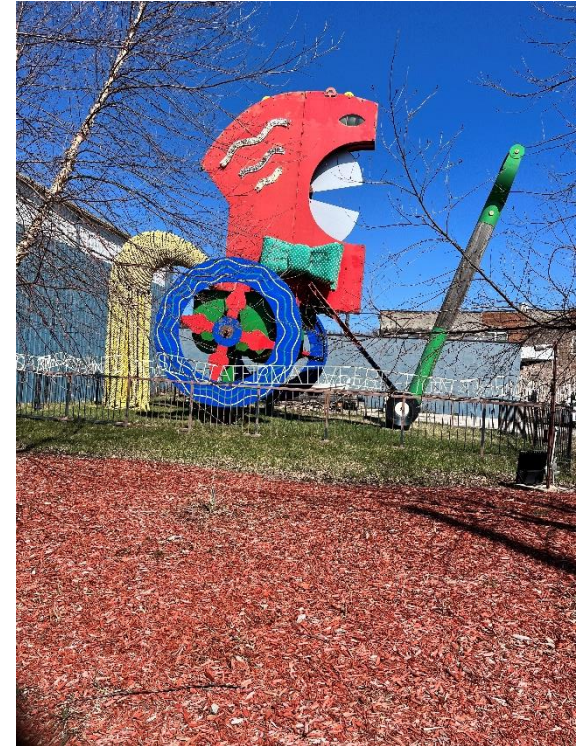

Project Review

- Sidewalk and Curb Repair (As Needed) includes removal of ~25,000 square feet of sidewalk with establishment of low mow grass tree lawns.
- Drive apron Replacements (As Needed)
- ADA Curb Ramps
- Trees will be planted at various locations in coordination with Urban Forestry
- Pedestrian signal upgrades – 8 solar powered Rectangular Rapid Flashing Beacons at E 32nd, E 36th, E 38th, and E 45th Streets
- Signal Removal at E 32nd, E 36th, and E 45th Streets
- Refurbishing existing mast arms at E 40th Street

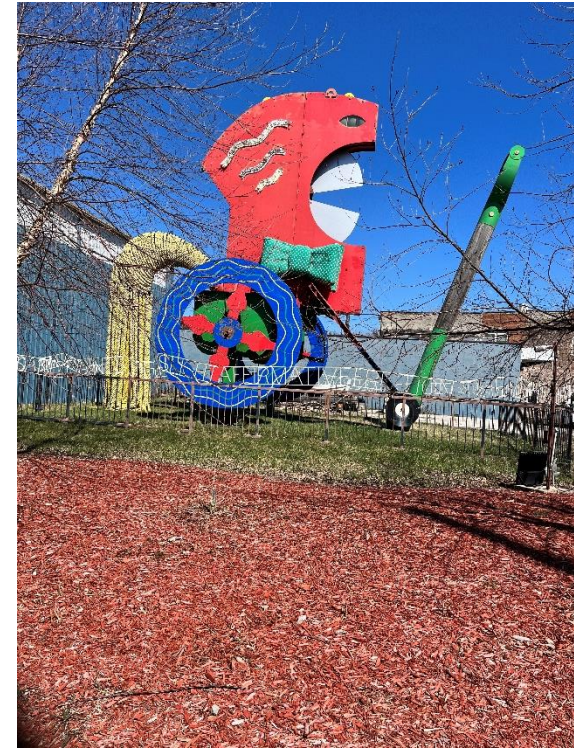

Construction

Schedule

- Construction Start: July 2025
- Construction End: November 2026

General Conditions

- Permitted Working Hours are 7:00 am to 7:00 pm per City's Noise Ordinance.
- Access to driveways will be maintained, in coordination with construction activities.
- If short-term closures are needed at side streets or driveways, special notice will be given.
- The contractor will keep the streets as clean as possible, using water and street sweeping.



MAINTENANCE OF TRAFFIC

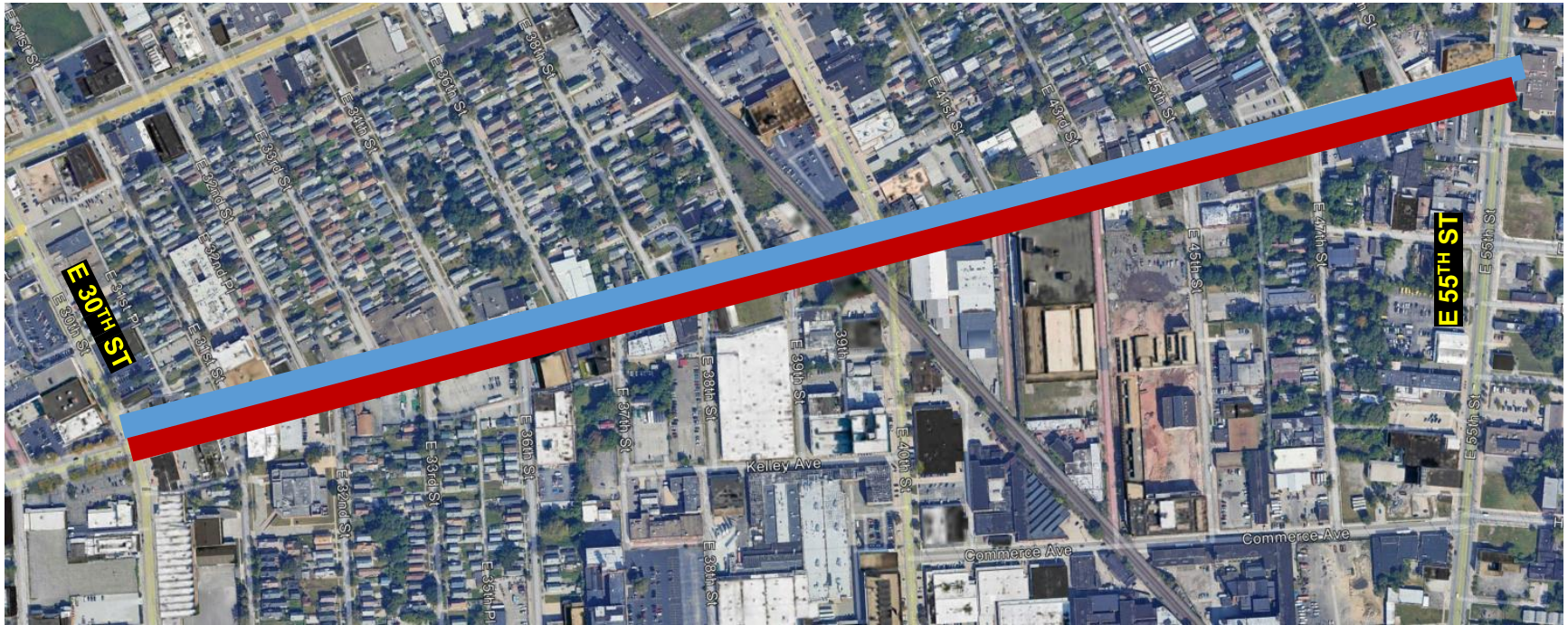

Maintenance of Traffic

Stage 1 – East 30th Street to East 55th Street

- Maintains one lane of traffic each direction (south side)
- Construction on north side of road

Stage 2 – East 30th Street to East 55th Street

- Maintains one lane of traffic each direction (north side)
- Construction on south side of road

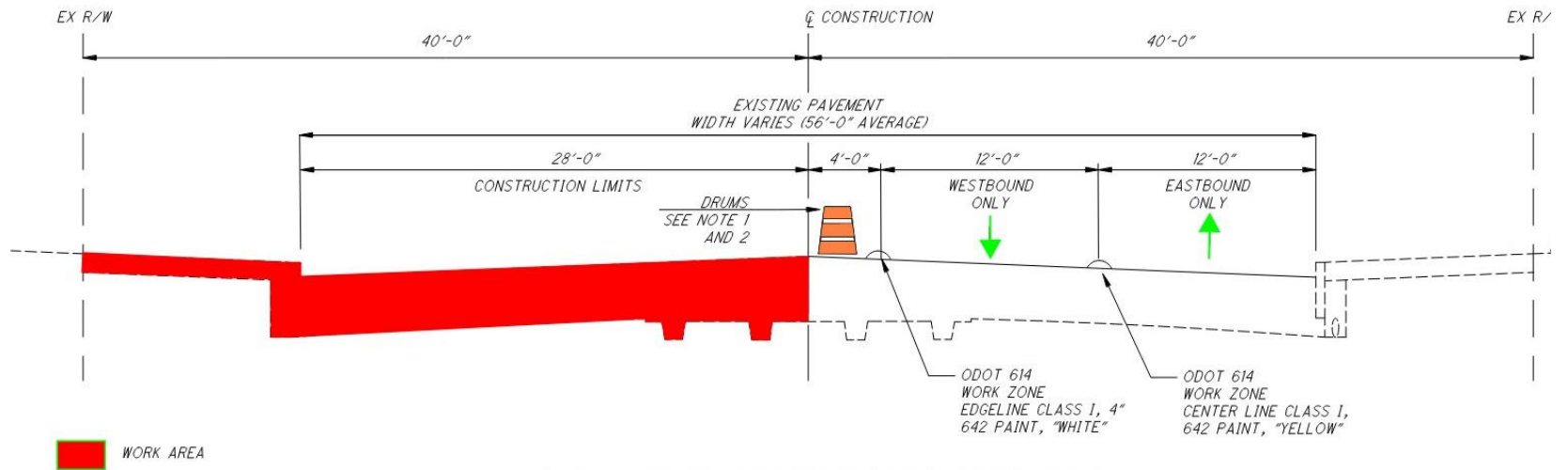

PAYNE AVENUE CONSTRUCTION ZONE STAGE 1

NOT TO SCALE



CITY OF CLEVELAND
Mayor Justin M. Bibb

PAYNE AVENUE REHABILITATION – PHASE 2



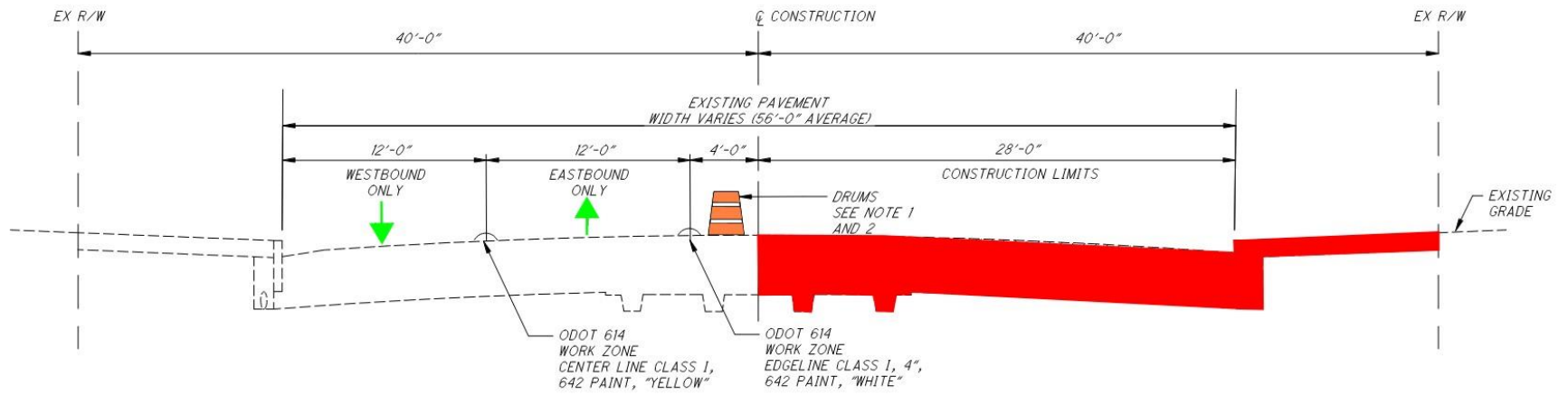

 WORK AREA

PAYNE AVENUE CONSTRUCTION ZONE STAGE 2
NOT TO SCALE

TREE LAWN LOCATIONS



East 30TH ST. to EAST 31ST ST.



East 32ND ST. to EAST 33RD ST.

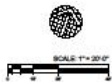

UNCALCULATED
DATE
C.I.B.

PAYNE AVENUE

173

TREE LAWN LOCATIONS



East 33RD ST. to EAST 36TH ST.



East 36TH ST. to EAST 38TH ST.



REVISIONS
DATE
BY

PROJECT INFORMATION

PAYNE AVENUE

173

TREE LAWN LOCATIONS



East 39TH ST. to EAST 40TH ST.



East 40TH ST.



UNCLIPPED DRAWING C.I.B.
PAYNE AVENUE
173

TREE LAWN LOCATIONS



East 41ST ST. to EAST 43RD ST.



East 43RD ST. to EAST 45TH ST.



UNAPPORTIONED
SHEET NO. 173

PAYNE AVENUE

173

TREE LAWN LOCATIONS



Contacts

Website

- For general information, project updates, and to leave comments please visit our project website:
- <https://payneaverehab.com/phase-2/>

For construction-related concerns or problems, please contact a member of the Construction Team:

- Cecil Benson
Inspector 216-857-7648
- Christy George, PE
Project Manger 216-664-2971

Contractor:

- After Hours Emergency: 216-861-8663

*PAYNE AVENUE REHABILITATION PHASE 2
FROM EAST 30TH STREET TO EAST 55TH STREET*

QUESTIONS & COMMENTS

MAYOR'S OFFICE OF CAPITAL PROJECTS



CITY OF CLEVELAND
Mayor Justin M. Bibb